

Main Street

3488 Main Street, Salt Lake City, Utah 84115



Roderick Realty
SERVICES

www.roderickrealty.com

801-506-5005

- Office, Retail, Showroom, Warehouse
- 8 Ground Level, 2 Dock High +Doors
- 20' Clear Height
- High Traffic Counts: 134,000
- Prime Main Street, Central Location

Main Street

3488 Main Street, Salt Lake City, Utah 84115

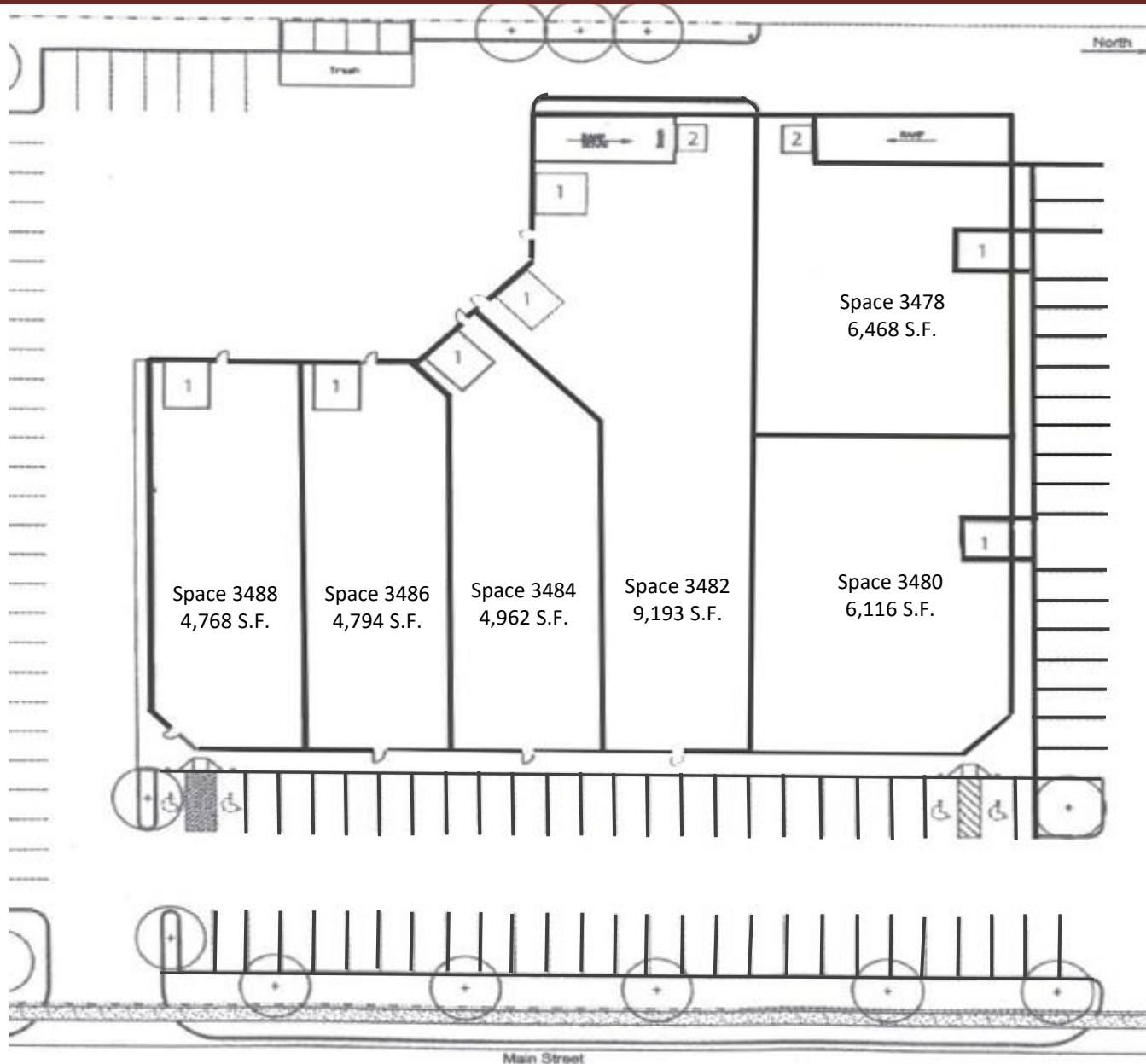

Building Data:

- Building Size: 36,301 S.F.
- Land Size: 97,200 S.F.
- Parking Stalls: 101

- 1 = 12' x 14' Ground Level Door
- 2 = 10' x 10' Dock High Door

Main Street Demographics

Population:	199,723
Households:	79,264
Income:	\$60,676



Roderick Realty
SERVICES
www.roderickrealty.com
801-506-5005

The information contained herein has been given to us by the owner or obtained from other reliable sources. We have no reason to doubt its accuracy but we do not guarantee it. Vacancy factors, projections, opinions, assumptions or estimates used herein are for example only and represents the current or future performance of the property. The value of this investment depends on tax and other factors which should be evaluated by your tax financial and legal advisors. YOU AND YOUR ADVISOR SHOULD VERIFY PROPERTY INFORMATION TO DETERMINE TO YOUR SATISFACTION THE PROPERTY FOR YOUR NEEDS.

Main Street

3488 Main Street, Salt Lake City, Utah 84115

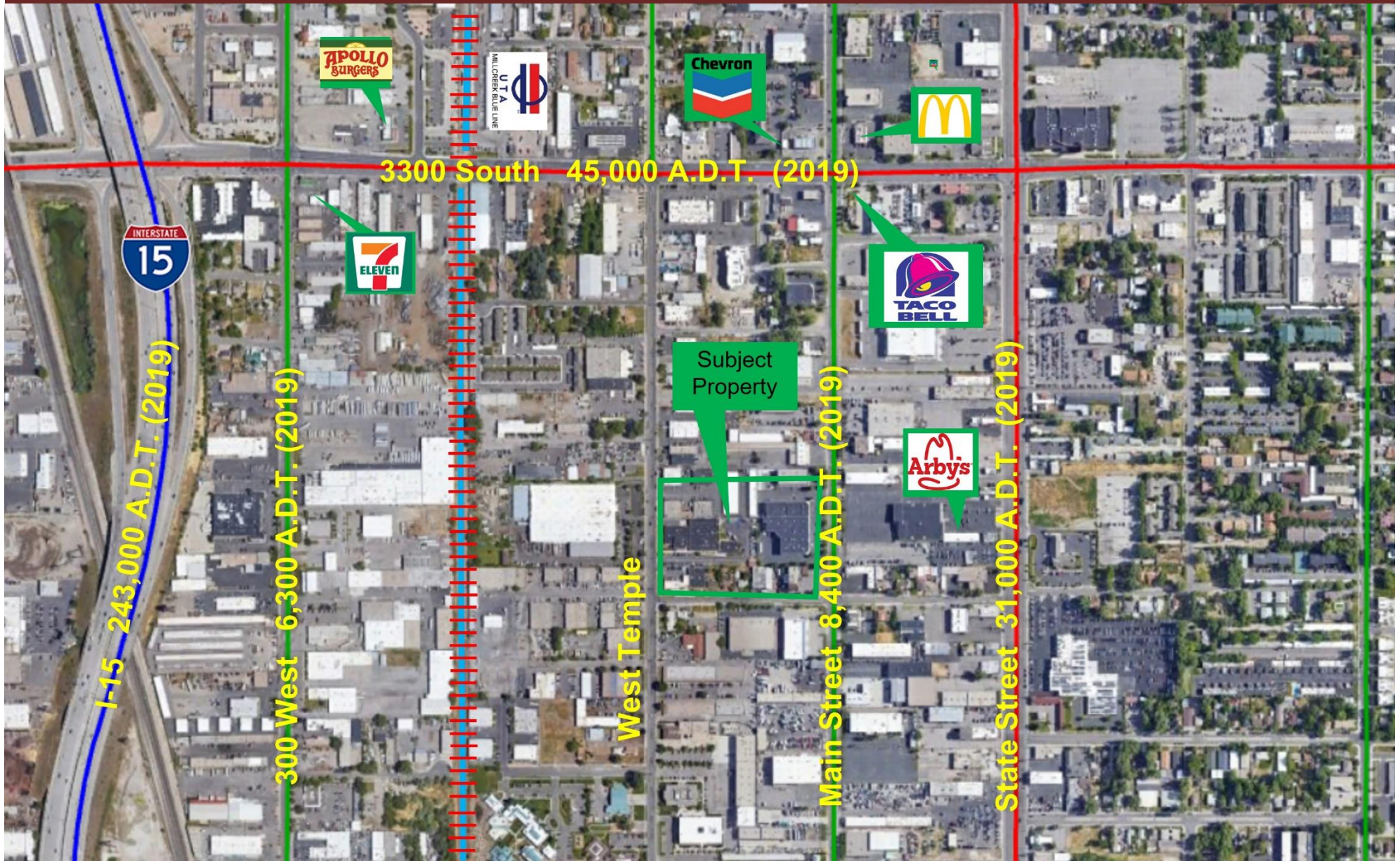

Roderick Realty
SERVICES
www.roderickrealty.com
801-506-5005

The information contained herein has been given to us by the owner or obtained from other reliable sources. We have no reason to doubt its accuracy but we do not guarantee it. Vacancy factors, projections, opinions, assumptions or estimates used herein are for example only and represents the current or future performance of the property. The value of this investment depends on tax and other factors which should be evaluated by your tax financial and legal advisors. YOU AND YOUR ADVISOR SHOULD VERIFY PROPERTY INFORMATION TO DETERMINE TO YOUR SATISFACTION THE PROPERTY FOR YOUR NEEDS.